



User Manual True Wireless Sound Earbuds

True Wireless Sound Earbuds

by

SOUNDSTREAM



Accessories list

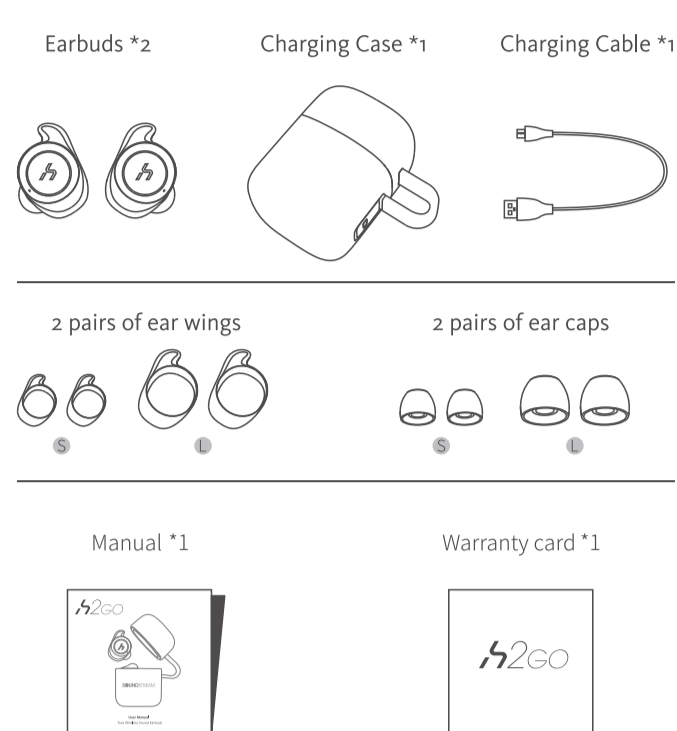

The product structure (with figures)

1. Multi-function button (MFB)
2. Microphone
3. LED Indicator Light
4. Charging Case
5. USB Charging Port
6. Charging case LED indicate light

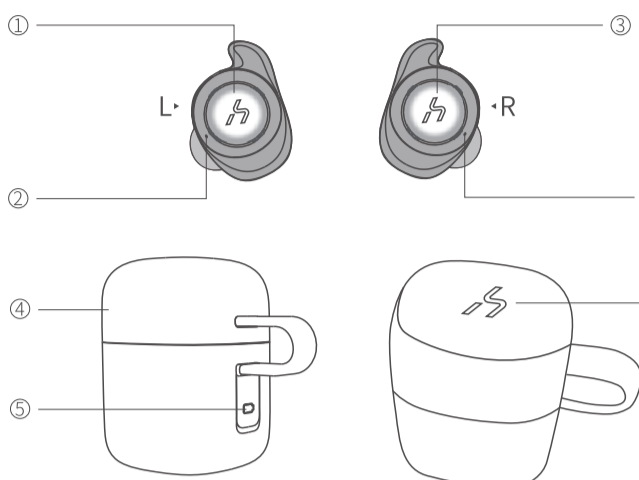

Preparation for use

1. Choose the preferred ear caps and wings.

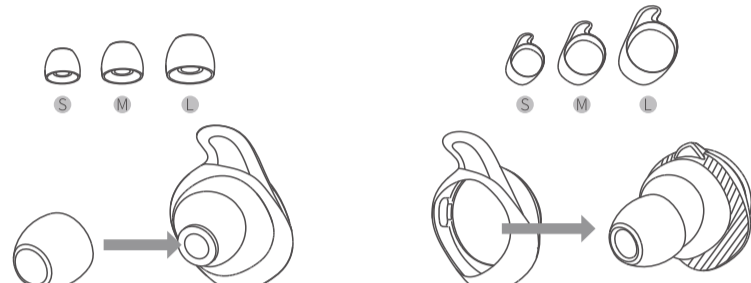

2. Plug

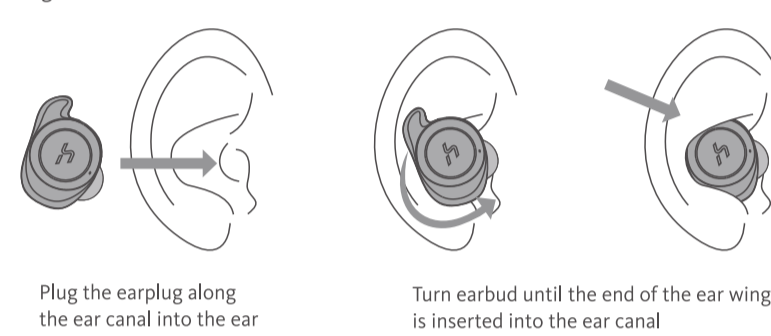

Binaural mode

Pairing Method 1:

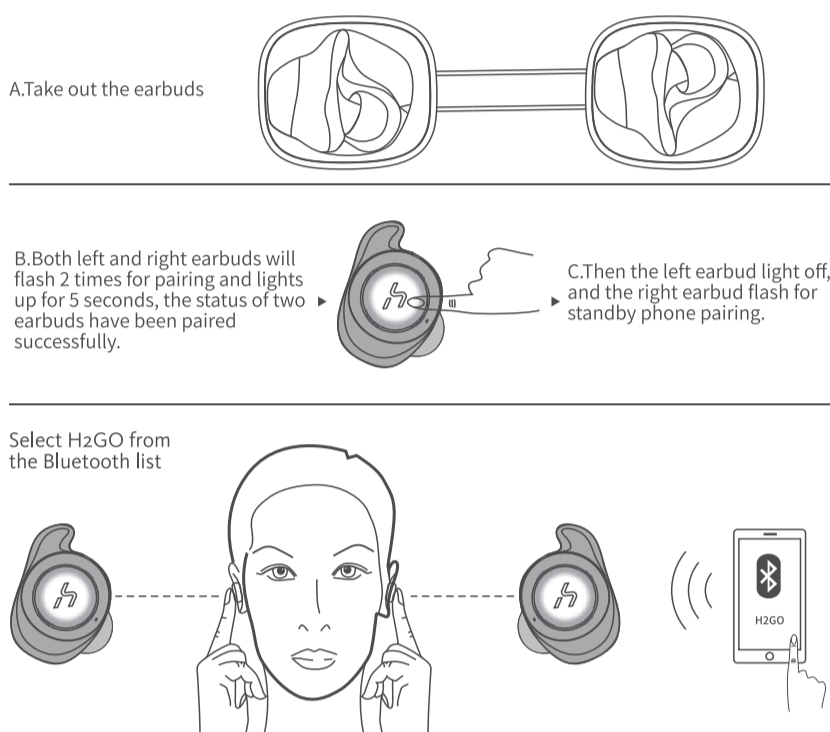

Select H2GO from the Bluetooth list

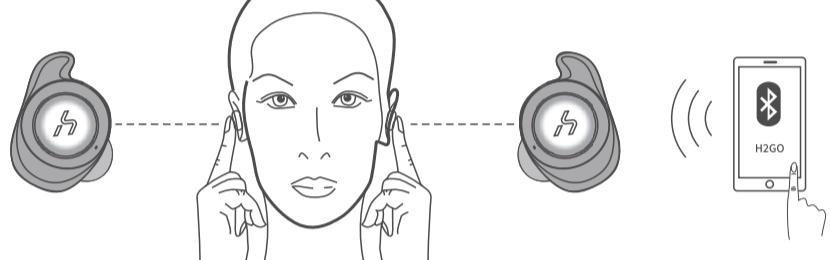

Pairing Method 2:

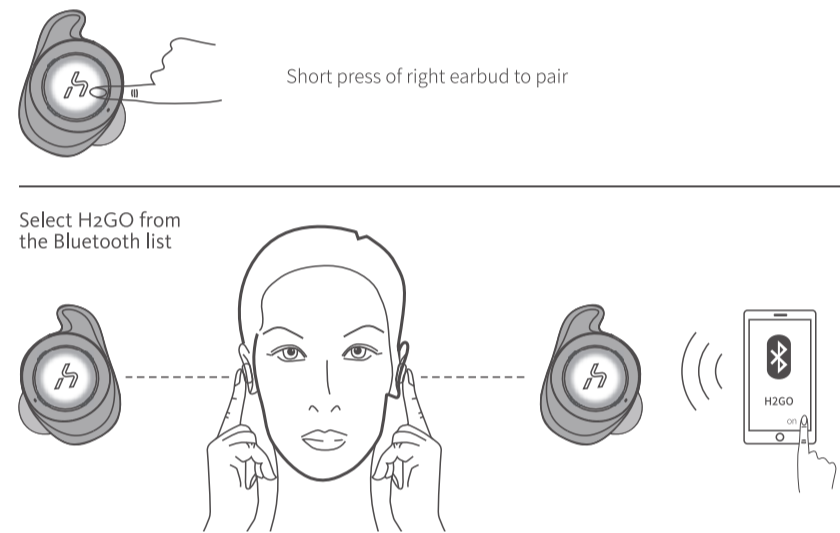

Notes:
 1. The maximum duration for pairing mode is 180 seconds. The LED of the right earbud will keep flashing. If you miss this time period, the LED light on both earbuds will flicker 3 times and go out. If you need to reconnect, please repeat the process as mentioned above.
 2. The earbud and mobile phone will default to the last pairing automatically (mobile Bluetooth is ON). The earbud TWS connects within 4 seconds, and the connection time between earbud and mobile phone is approximately 8 seconds.

3. If the earbud does not reconnect after disconnection, then the earbud will turn off automatically after 3 minutes.
4. If the search device name is "H2GO", it shows that there is no successful link between the left and right earbuds. Please restart the earbuds according to the pairing method.

Power off

Method 1:

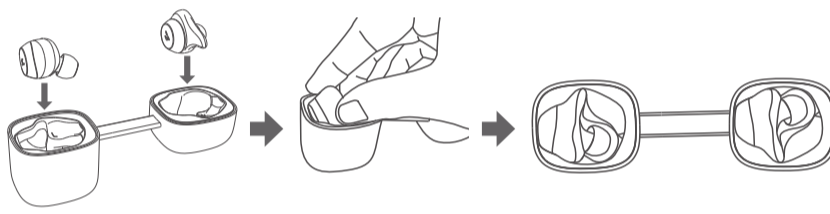

Method 2: Long press of the left or right earbud for 5 seconds



Answer a call

1. Just press the left / right earbuds (only use the right earbud for communication).

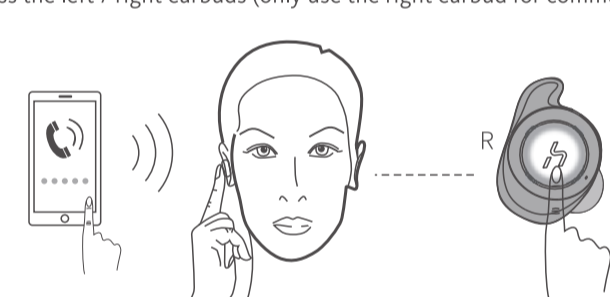

Note:
 Because part of the mobile phone receives calls by default through the phone receiver, Please set up the telephone answering settings according to the handset instructions.

2- If the phone is in use and another call comes in:

- Click the left / right earbud to keep the current phone call and answer the other call.
- Press the left / right earbud button for 1 second, declining to answer the other call.
- In three party calls, two phone calls can be switched by pressing the left / right earbud button for 1 second.
- Press the left / right earbud button for 1 second to keep the current call and connect the incoming call;

- Press the button of the left / right earbud, hang up the current call and connect the incoming call.

Reject a call

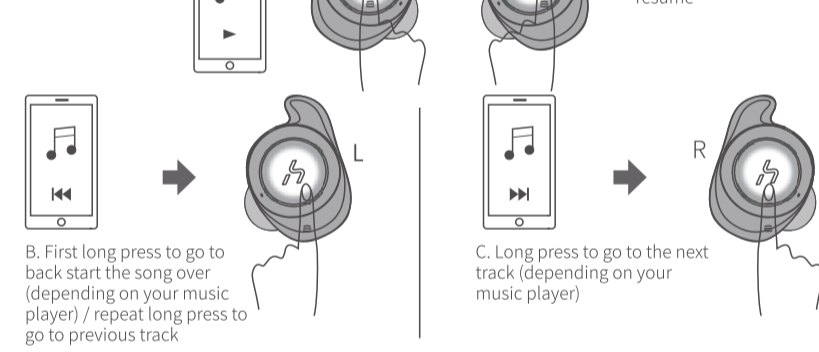
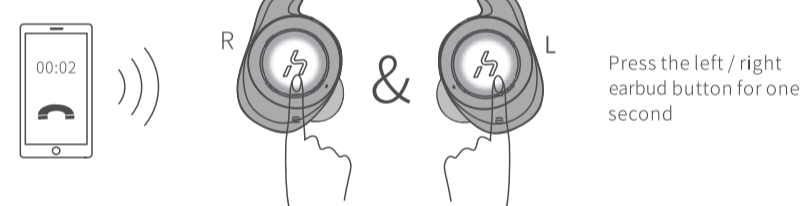

Note: Playing the next or previous track depends on your music player or App.

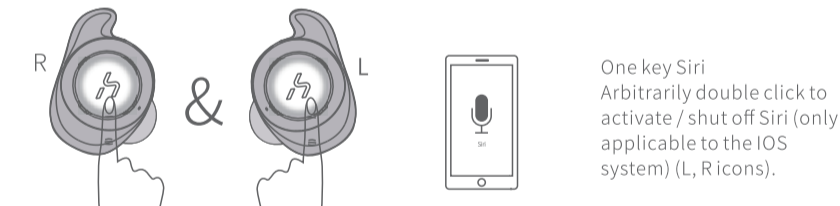

One key Siri
 Arbitrarily double click to activate / shut off Siri (only applicable to the IOS system) (L, R icons).

Charging the charging case

If the charging case battery is less than 10%, the white LED light will keep flashing to indicate low power while charging the earbuds.

Charging Case: Charging LED light gently flickers / White LED light turns off once charging is complete.

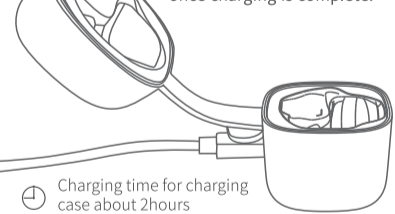

Wireless charging
 Support wireless charging, but not include a wireless charger

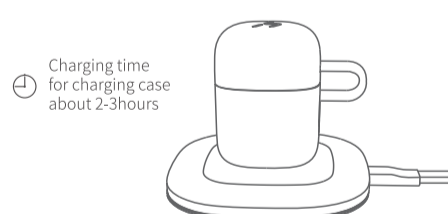

Charging time for charging case about 2-3hours

Charging the earbuds

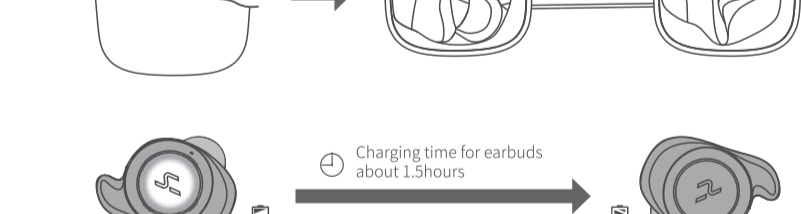
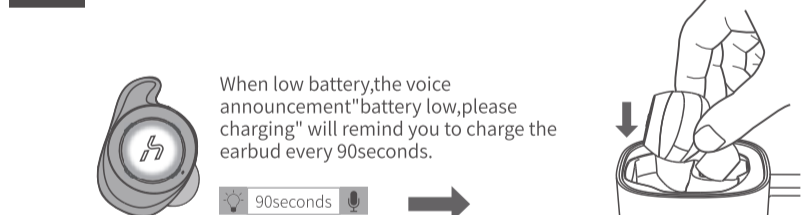

Earbuds: Charging if white LED gently flickers / White LED turns off once charging is complete.

Single channel mode (take out the right earbud as a single side Bluetooth earbud)

(Note: Single channel mode only needs the right earbud removed from the charging case. If used as a single earbud, two earbuds have been removed before being connected. The earbuds will be used as TWS mode by default and automatically realize TWS connection.)

- Turn on the earbud, the earbud will automatically enter the Bluetooth pairing mode, the white LED light flash once every 0.5 seconds.
- Turn on the mobile Bluetooth function to search the device. When the device name is "H2GO" click it to begin pairing. The white LED will begin to flash for 5 seconds and will indicate that pairing is successful.
- For more functional operations, please refer to the TWS mode.

Specification parameters

Bluetooth version: V5.0
 Charge box size: 38*60*60mm
 Earbud size: 22*28*29mm*2
 Product weight: 6g*2 (earphones) / 59g (charging box)
 Wireless connection distance: 10M (barrier free)
 Loudspeaker: 5.8MM, titanium film
 Loudspeaker sensitivity: 90 + 3dB 1kHz/1mW
 Support protocols: HSP, HFP, A2DP, AVRCP, TWS, AAC
 Impedance: 16 + 15% 1kHz

Loudspeaker frequency: 20Hz to 20KHz
 Input voltage / current: DC 5V/1A
 Earbud battery: 60mAh*2 (full of electricity in 1.5H)
 Charge box battery: 720mAh
 Playback time: 3.5H(50% volume)
 Call time: 4-5H
 Standby time: 80H
 Charging time: about 2H

Charging and battery information:

- This product has a built-in non-removable rechargeable battery. Please use the equipped micro USB cable to charge the battery.
- The charging current voltage is 5V/1A and the product cannot be recharged with a charger greater than 5V/1A.
- Please charge fully before the first use. The follow-up charges will take about 1.5 hours to fully charge. The charging case will take about 2 hours to fully charge.
- Please choose a charger that passes the regular manufacturers safety certification.
- Repeated charging on the earbuds will cause battery performance degradation over time, which is a normal occurrence for all rechargeable batteries.

Warning:

- Please follow the instructions in this manual.
- Do not use a charger exceeding the rated current and voltage of the headset (5V/1A) to charge the headset, otherwise it will cause damage to the headset battery.
- Please use and store this product in the ambient temperature environment.
- Do not use this product near the heat source, such as a radiator, a hot air conditioner, a stove, or other instruments that produce heat.
- Don't block the ports of the headset, such as charging indicator lights and microphone etc..
- Please don't adjust the volume to the maximum level for a long time to avoid causing dizziness or damage to hearing.
- No matter the product is damaged for any reason, it must be dealt with in time with the after-sale personnel of us. Any unauthorized demolition and modification will make the warranty invalid.

FCC STATEMENT :

This device complies with Part 15 of the FCC Rules. Operation is subject to the following two conditions:
 (1) This device may not cause harmful interference, and
 (2) This device must accept any interference received, including interference that may cause undesired operation.

Warning: Changes or modifications not expressly approved by the party responsible for compliance could void the user's authority to operate the equipment.

NOTE:

This equipment has been tested and found to comply with the limits for a Class B digital device, pursuant to Part 15 of the FCC Rules. These limits are designed to provide reasonable protection against harmful interference in a residential installation. This equipment generates uses and can radiate radio frequency energy and, if not installed and used in accordance with the instructions, may cause harmful interference to radio communications. However, there is no guarantee that interference will not occur in a particular installation. If this equipment does cause harmful interference to radio or television reception, which can be determined by turning the equipment off and on, the user is encouraged to try to correct the interference by one or more of the following measures:
 Reorient or relocate the receiving antenna.
 Increase the separation between the equipment and receiver.
 Connect the equipment into an outlet on a circuit different from that to which the receiver is connected.

Consult the dealer or an experienced radio/TV technician for help.

FCC Radiation Exposure Statement:

This equipment complies with FCC radiation exposure limits set forth for an uncontrolled environment. This equipment should be installed and operated with minimum distance 10cm between the radiator & your body.